

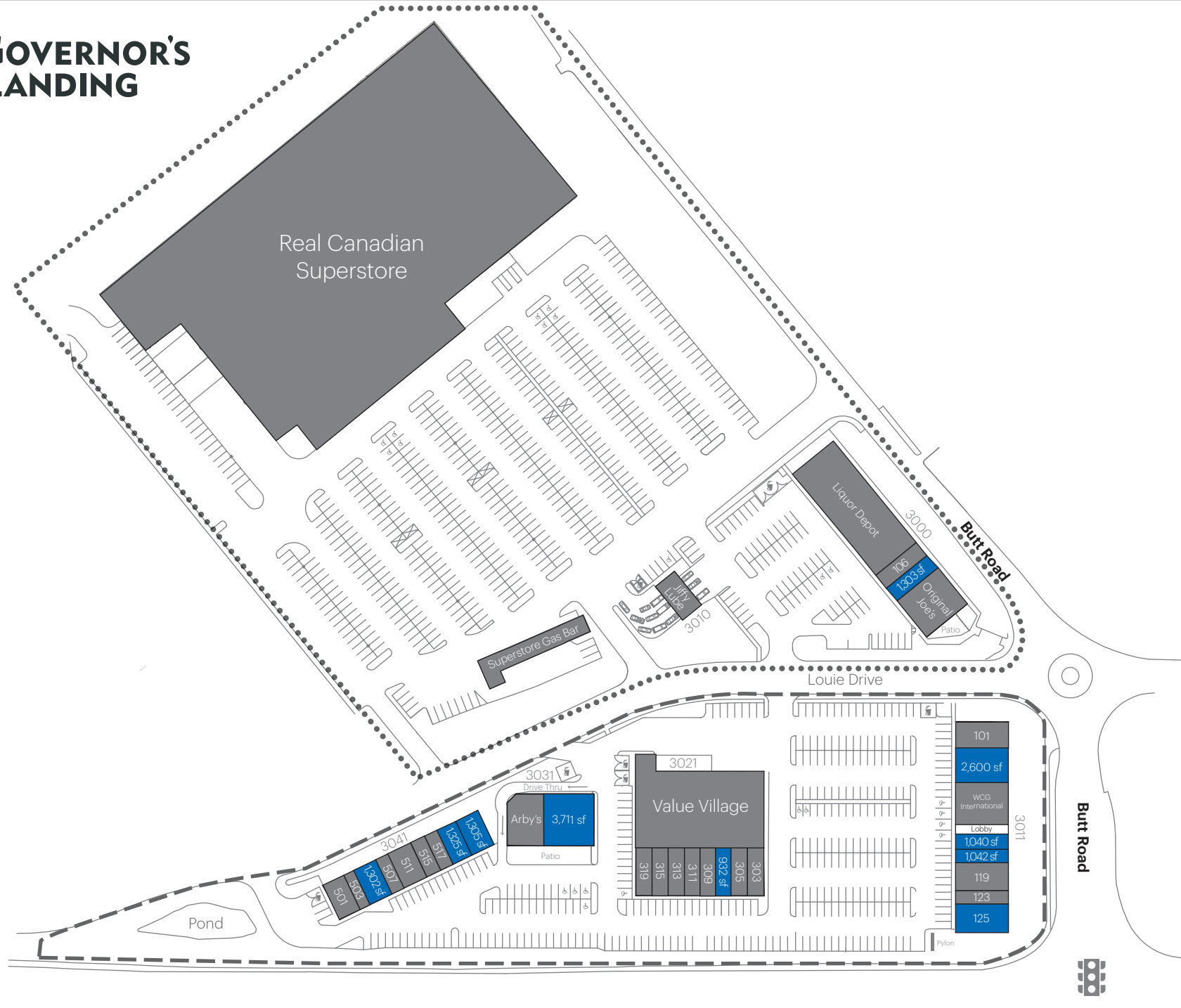

# Governor's Landing

3000 Louie Drive, West Kelowna, BC



| Unit #     | Sq.ft. | Tenant Name                    |
|------------|--------|--------------------------------|
| PAD - 3020 |        | Real Canadian Superstore       |
| 102 - 3000 | 9,969  | Liquor Depot                   |
| 106 - 3000 | 1,572  | Easy Financial                 |
| 110 - 3000 | 1,303  | Available                      |
| 114 - 3000 | 3,921  | Original Joe's Restaurant      |
| PAD - 3010 | 1,642  | Jiffy Lube                     |
| 101 - 3011 | 2,083  | Outbound Cycle                 |
| 105 - 3011 | 2,600  | Available                      |
| 109 - 3011 | 3,120  | WCG International              |
| 115 - 3011 | 1,040  | Available                      |
| 117 - 3011 | 1,042  | Available                      |
| 119 - 3011 | 2,082  | Sunshine Pet Food & Supplies   |
| 123 - 3011 | 1,042  | The Cash Store                 |
| 125 - 3011 | 2,600  | Available                      |
| 301 - 3021 | 14,564 | Value Village                  |
| 303 - 3021 | 1,236  | Ginza Sushi                    |
| 305 - 3021 | 1,166  | Repair Express                 |
| 307 - 3021 | 932    | Available                      |
| 309 - 3021 | 932    | Water Canada                   |
| 311 - 3021 | 932    | Coldwell Banker Horizon Realty |
| 313 - 3021 | 932    | Miso Hair                      |
| 315 - 3021 | 1,848  | Benjamin Moore                 |
| 319 - 3021 | 1,023  | Tandori Grill                  |
| 401 - 3031 | 2,822  | Arby's                         |
| 403 - 3031 | 3,711  | Available                      |
| 501 - 3041 | 1,318  | Toa Rice + Noodle              |
| 503 - 3041 | 746    | Booster Juice                  |
| 505 - 3041 | 1,302  | Available                      |
| 507 - 3041 | 746    | Rogers Wireless                |
| 511 - 3041 | 1,208  | Johnson Meier Insurance        |
| 515 - 3041 | 996    | Great Clips                    |
| 517 - 3041 | 751    | Liberty Tax Services           |
| 519 - 3041 | 1,325  | Available                      |
| 523 - 3041 | 1,305  | Available                      |



Leased   
  Available   
  Governor's Landing A   
  Governor's Landing B

This is a representation for leasing purposes only and should not be used for measurements or co-tenancy of any kind. This drawing is not to scale.

**Anthem**  
anthemproperties.com

**Mike Peebles**  
mpeebles@anthemproperties.com  
604 638 4389



### 2nd Floor Office

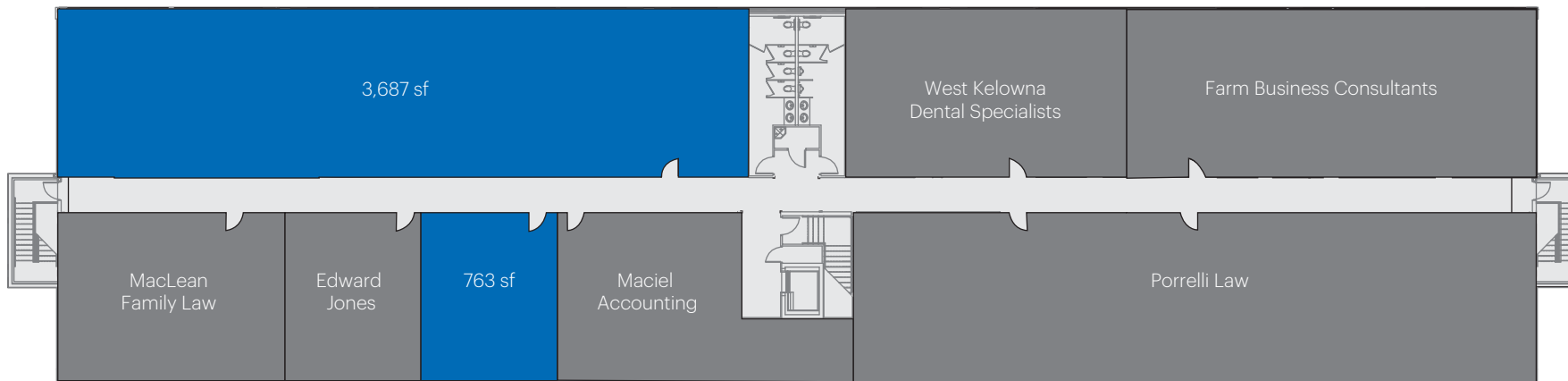

| Unit #     | Sq.ft. | Tenant Name                     |
|------------|--------|---------------------------------|
| 207 - 3011 | 1,278  | MacLean Family Law              |
| 209 - 3011 | 3,687  | Available                       |
| 203 - 3011 | 798    | Edward Jones                    |
| 208 - 3011 | 763    | Available                       |
| 215 - 3011 | 1,591  | West Kelowna Dental Specialists |
| 217 - 3011 | 1,272  | Maciel & Co Accounting          |
| 221 - 3011 | 3,890  | Porrelli Law                    |
| 227 - 3011 | 2,293  | Farm Business Consultants       |



Leased
  Available
  Common Areas
  Separate Ownership

This is a representation for leasing purposes only and should not be used for measurements or co-tenancy of any kind. This drawing is not to scale.